



**INSTALLATION INSTRUCTIONS FOR MOUNTING
STAKE POCKET BED RAILS – MODEL #'s 510020, 510030, 510040, 510080, 510090**

TRUCK MODELS:

- 510020** 99-07 GM CLASSIC 6.5' BOX
- 510020** 2002 DODGE 1500 SHORT BOX
- 510030** 1997 FORD F-150 SHORT BOX
- 510030** 1999 FORD F-250, F-350 SHORT BOX
- 510040** 04-07 GM CLASSIC 5.8' BOX
- 510080** 2007 GM 5.8' BOX
- 510090** 2007 GM 6.5' BOX

1. READ THE INSTRUCTIONS COMPLETELY AND CHECK TO MAKE SURE THAT ALL OF THE REQUIRED PARTS ARE ON HAND BEFORE STARTING THE INSTALLATION.
2. PREASSEMBLE MULTI THREAD U-NUT (4) TO THE ZINC PLATED NUT PLATE (4) AS SHOWN IN FIGURE #1. REPEAT FOR ALL 4 PLATES.
3. ASSEMBLE THE BED RAIL ASSEMBLY:
 - A. INSERT THE 5/16-18 X 2-1/2" SST BUTTON HEAD SCREW (6) THROUGH ACCESS HOLE AND ATTACH TO THE BED RAIL (1) VIA SST WELD PLATE.
 - B. SLIDE THE PLASTIC PLATE (2) OVER THE 5/16" SCREW (6), AND ATTACH THE NUT PLATE ASSEMBLY (3,4) TO THE BOLT SO THAT THE THREADS ARE JUST TO THE BOTTOM END OF THE U-NUT.
4. PLACE THE BED RAIL ASSEMBLY OVER THE STAKE POCKETS AND CAREFULLY WORK THE NUT PLATE ASSEMBLY (3,4) INTO THE STAKE POCKETS.
5. USING A 3/16" ALLEN HEAD WRENCH, TIGHTEN DOWN THE BED RAIL TO THE TOP OF THE BED. MAKE SURE THAT THE PLASTIC SPACER COVERS BOTH STAKE POCKETS.
6. INSERT THE 9/16" DIA HOLE PLUG INTO BED RAIL ASSEMBLY.
7. REPEAT FOR OPPOSITE SIDE.

ITEM	PART #	QTY	DESCRIPTION
1	510022	2	TUBE WLDMT 72.19" #510020
1	510032	2	TUBE WLDMT 75.69" #510030
1	510042	2	TUBE WLDMT 62.69" #510040
1	510082	2	TUBE WLDMT 60.69" #510080
1	510092	2	TUBE WLDMT 70.19" #510090
2	104845	4	SPACER-PLASTIC 2.25 X 3.50
3	510027	4	PLATE-NUT ZINC PLATED
4	104264	4	MULTI THREAD U-NUT 5/16-18
5	104844	6	PLUG, BPF 9/16, BLACK LDPE
6	104837	4	5/16-18 X 2-1/2" SST BTN HD SCREW

INSTALLATION INSTRUCTIONS

MODEL NO.
510020
510030
510040
510080
510090

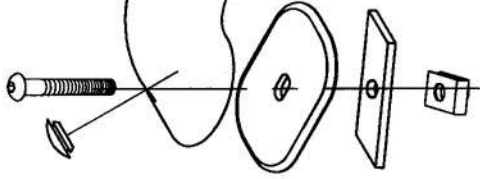

TRUCK

fig. #2

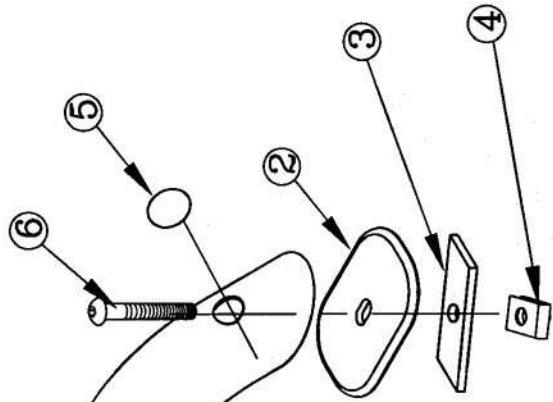

fig #1

