



## INSTALLATION INSTRUCTIONS FOR MOUNTING

LUVERNE GRILLE GUARDS WITH THE FOLLOWING MODEL NO.:  
205105 ON:

1997 AND NEWER PETERBILT MODEL 379 TRACTORS

1. READ THE INSTRUCTIONS COMPLETELY AND CHECK TO MAKE SURE THAT ALL OF THE REQUIRED PARTS ARE ON HAND BEFORE STARTING THE INSTALLATION. THE INSTALLATION REQUIRES:

(1) GRILLE GUARD PACKAGE:

- (1) GRILLE GUARD, SST
- (1) ASSEMBLED UPRIGHT MOUNTING BRACKET, RH
- (1) ASSEMBLED UPRIGHT MOUNTING BRACKET, LH
- (1) BUMPER MOUNTING BRACKET, RH
- (1) BUMPER MOUNTING BRACKET, LH
- (1) MOUNTING HARDWARE PACKAGE

**REFER TO SERVICE PARTS LIST AND FIG. 1 FOR STEPS 1-11**



2. OPEN THE HOOD AND REMOVE THE THREE - (6) 1/2" BOLTS, NUTS AND WASHERS HOLDING THE BUMPER TO THE FRAME. (DRIVERS SIDE SHOWN)



3. ATTACH THE HINGE CHANNELS TO THE BUMPER MOUNTING BRACKETS. (DRIVERS SIDE SHOWN)

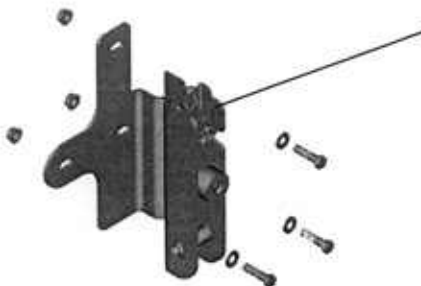

4. INSTALL THE RIGHT HAND AND LEFT HAND MOUNTING BRACKETS (ITEM #2/4 & #3/5) TO THE FACE OF THE BUMPER USING THE 1/2-13 X 2 HEX BOLTS, 1/2" FLAT WASHERS AND 1/2-13 FLANGE NUTS. DO NOT TIGHTEN AT THIS TIME. THE FLANGES OF THE MOUNTING BRACKETS SHOULD FACE TO THE INSIDE. LEAVE THE FASTENERS LOOSE ENOUGH SO THAT THE BRACKET CAN BE MOVED. (DRIVERS SIDE SHOWN)

**LUVERNE**  
TRUCK EQUIPMENT  
(A LUVERNE Company)

1200 E. Birch St.

Brandon, SD 57005

REVISED 03JAN08 LVL B  
REVISED 08MAY03 LVL A  
205125 SHEET 1 OF 6 15JAN03



5. INSTALL THE GRILLE GUARD ONTO THE MOUNTING BRACKETS USING THE TWO MACHINE PINS (ITEM #9) AND THE HAIR PINS (ITEM #10).



6. CLOSE THE GRILLE GUARD ON THE MOUNTING BRACKETS, JUST TO THE FIRST CATCH, SO THAT THE MOUNTING BRACKETS CAN BE ADJUSTED.

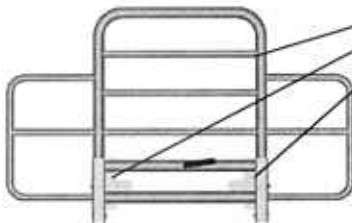

7. WITH THE GRILLE GUARD IN THE CLOSED POSITION, ALIGN THE MOUNTING BRACKETS SO THAT THEY CENTER THE GRILLE GUARD ON THE VEHICLE. POSITION THE BRACKETS SO THAT THE END OF THE HINGE TUBE ON THE INSIDE OF THE BRACKET IS AGAINST THE INSIDE OF THE UPRIGHT. TIGHTEN THE MOUNTING BRACKET BOLTS.

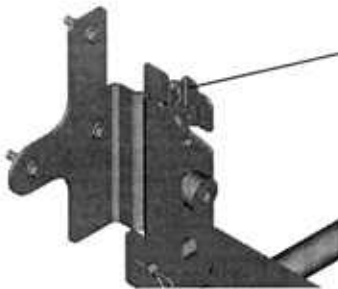

8. PULL THE CATCH RELEASE LEVERS AND CAREFULLY LOWER THE GRILLE GUARD. OPEN THE HOOD. TIGHTEN THE SIX (6) MOUNTING BRACKET BOLTS.

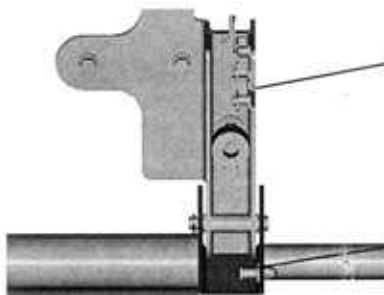

9. CLOSE THE HOOD AND CAREFULLY RAISE THE GRILLE GUARD. CHECK THAT THE UPRIGHT CHANNEL OF THE MOUNTING BRACKET DOES NOT INTERFERE WITH THE WASHER ON THE STRIKER PIN (ITEM #8).

STRIKER PIN WASHER

**LIVERNE**  
TRUCK EQUIPMENT  
(A LIVERNE Company)

1200 E. Birch St.

Brandon, SD 57005

REVISED 03JAN08 LVL B  
REVISED 08MAY03 LVL A  
205125 SHEET 2 OF 6 15JAN03



10. TO CLOSE THE GRILLE GUARD, APPLY PRESSURE TO THE TOP CENTER OF THE GRILLE GUARD UNTIL THE RUBBER BUMPERS IN THE MOUNTING BRACKETS COMPRESS, AND THE LATCH CLICKS TO THE SECOND SETTING.

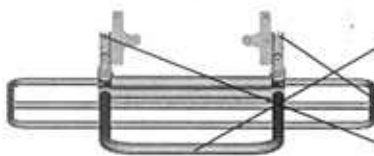

11. TO LOWER THE GRILLE GUARD, APPLY PRESSURE TO THE TOP CENTER OF THE GRILLE GUARD AND RELEASE THE RIGHT SIDE AND LEFT SIDE LATCH LEVERS TO THE FIRST CATCH. THIS WILL TAKE THE PRESSURE OFF OF THE RUBBER BUMPERS. NOW RELEASE BOTH LEVERS AND LOWER THE GUARD TO THE BOTTOM.

LATCH LEVERS



COMPLETED GRILL GUARD

#### DAMPENER ADJUSTMENT

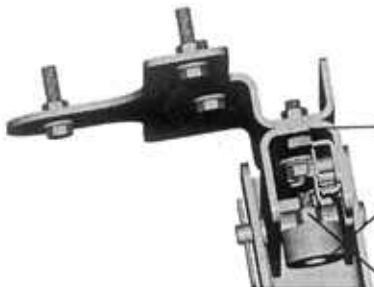

THE DAMPENER IS SET AT THE FACTORY, TO APPROXIMATELY 3-9/16" FROM THE INSIDE SURFACE OF THE CHANNEL TO THE FACE OF THE DAMPENER, BUT SHOULD IT EVER NEED TO BE ADJUSTED, FOLLOW THESE STEPS:

1. REMOVE THE DAMPENER (ITEM #25) AND THE WASHER (ITEM #23) SEE SHEET #5 & #6 FIG.1 & FIG.2
2. ADJUST THE NYLOCK NUT (ITEM #20), BEHIND THE DAMPENER, IN OR OUT AS REQUIRED.
3. REINSTALL THE DAMPENER AND WASHER

IF THE DAMPENER IS TOO LOOSE, THERE WILL BE EXCESSIVE PLAY IN THE GUARD. IF THE DAMPENER IS TOO TIGHT THERE WILL BE EXCESSIVE PRESSURE ON THE LATCH.

**LIVERNE**  
TRUCK EQUIPMENT

(A LIVERNE Company)

1200 E. Birch St.

Brandon, SD 57005

REVISED 03JAN08 LVL B  
REVISED 08MAY03 LVL A  
205125 SHEET 3 OF 6 15JAN03

**SERVICE PARTS LIST**

ITEM	PART NO.	QTY	DESCRIPTION
1	205108	1	RING WELDMENT - SST
2	205126	1	MOUNTING BRACKET WELDMENT - RH, ZP
3	205127	1	MOUNTING BRACKET WELDMENT - LH, ZP
4	205128	1	BUMPER MOUNTING BRACKET - RH, ZP
5	205129	1	BUMPER MOUNTING BRACKET - LH, ZP
6	105222	1	ROTARY LATCH - RH
7	105223	1	ROTARY LATCH - LH
8	105224	2	STRIKER PIN
9	105263	2	MACHINE PIN - Ø5/8 X 3-5/8, ZP
10	100159	2	HAIR PIN - 9GA, ZP
11	105261	1	STEP PAD - 31"
12	105260	2	STEP PAD - 19"
13	105656	4	SCREW - HHC, 9/16-12 X 1-1/2, SST
14	100091	6	SCREW - HHC, 1/2-13 X 2, ZP
15	100104	2	BOLT - CARRIAGE, 1/2-13 X 3-1/2, FT, ZP
16			
17	100647	6	SCREW - HHC, 5/16-18 X 1, ZP
18	105655	4	NUT - NYLOCK, 9/16-12, SST
19	100123	8	NUT - SERRATED FLANGE, 1/2-13, ZP
20	105654	2	NUT - NYLOCK, 1/2-13, ZP
21	105254	2	NUT - CAP (ACORN), 7/16-14, SST
22	104995	6	WASHER - FLAT, SAE, 1/2, SST
23	105257	2	WASHER - Ø2.000X Ø0.516 X .104, STEEL, ZP
24	100140	2	WASHER - FLAT, 9/16, ZP
25	105256	2	BUMPER - ELASTOMER, Ø2"



(A LIVERNE Company)

1200 E. Birch St.

Brandon, SD 57005

REVISED 03JAN08 LVL B  
REVISED 08MAY03 LVL A  
205125 SHEET 4 OF 6 15JAN03

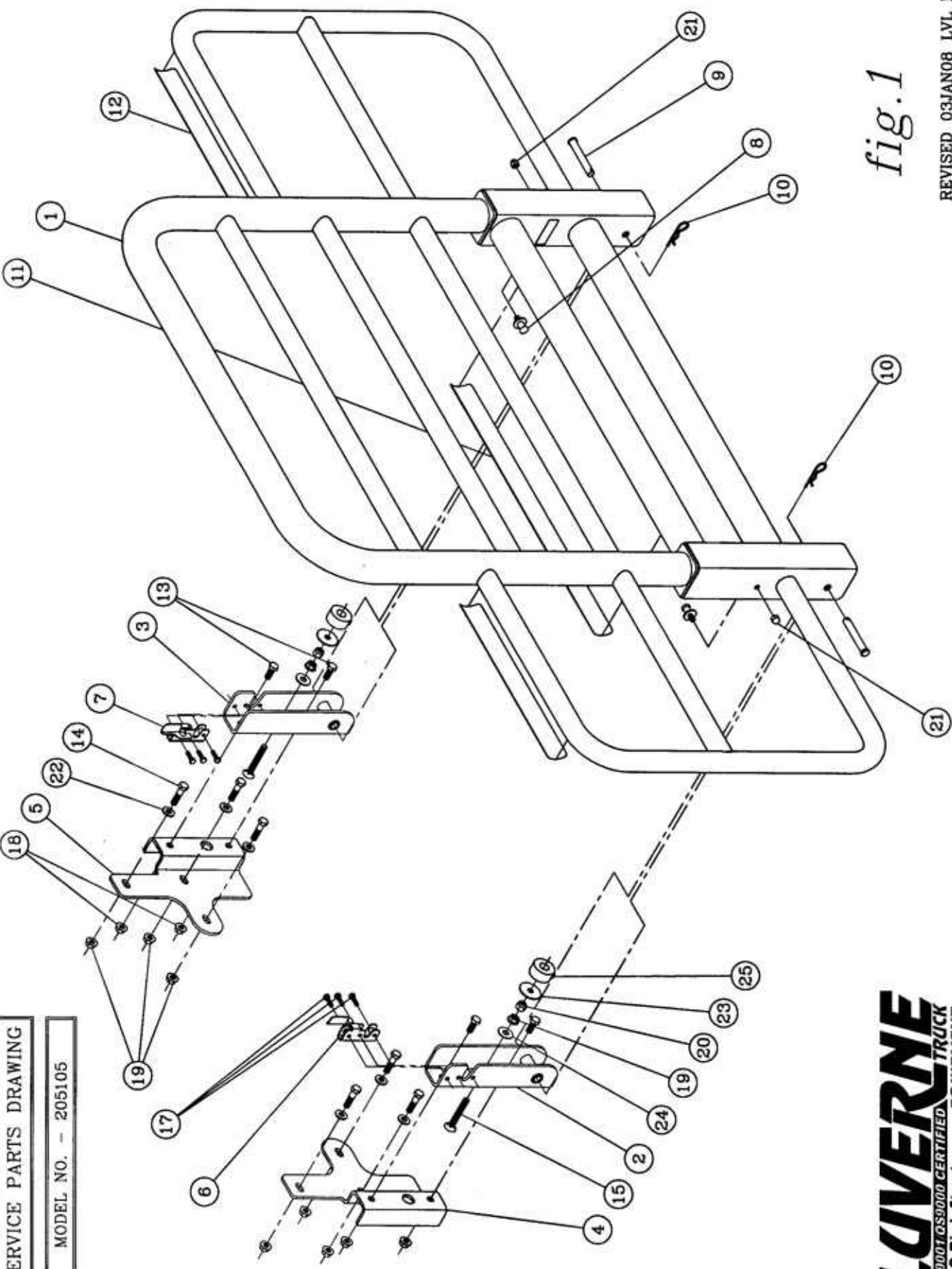

SERVICE PARTS DRAWING  
 MODEL NO. - 205105

fig.1

REVISED 03JAN08 LVL B  
 REVISED 08MAY03 LVL A  
 205125 SHEET 5 OF 6 15JAN03

**LIVERNE**  
 ISO9001 CERTIFIED TRUCK  
 1700 Birch Street EQUIPMENT  
 Brandon, SD 57005 INC

DAMPENER ADJUSTMENT

fig.2

(ITEM #20) NYLOCK NUT

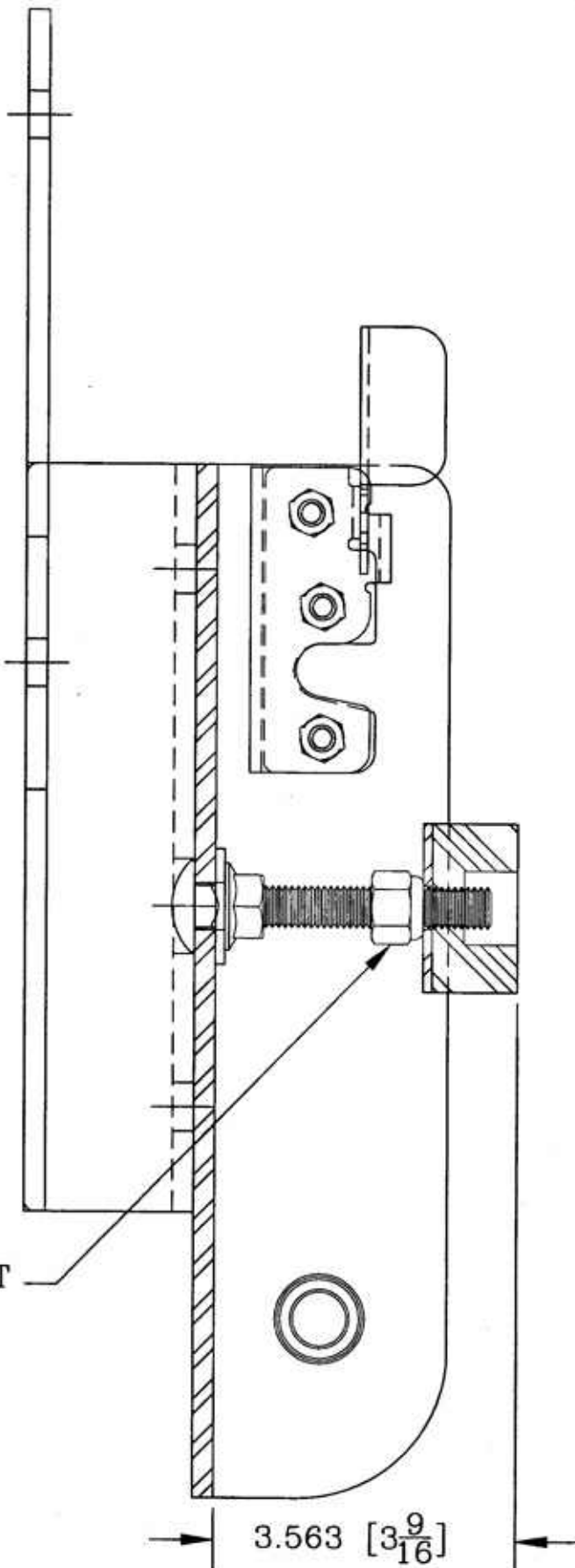

(A LIVERNE Company)

1200 E. Birch St.

Brandon, SD 57005

REVISED 03JAN08 LVL B  
REVISED 08MAY03 LVL A  
205125 SHEET 6 OF 6 15JAN03