

**CLASS 8 FREIGHTLINER COLUMBIA
(2ND HALF 2002-CURRENT)**

APPLICATIONS

THIS GRILLE GUARD WILL FIT ALL NEW FREIGHTLINER COLUMBIA'S STARTING WITH THE 2ND HALF OF THE 2002 MODEL YEAR TO CURRENT.

INSTALLATION INSTRUCTIONS

1. PLEASE READ ALL INSTRUCTIONS COMPLETELY AND CAREFULLY PRIOR TO INSTALLATION. REFER TO FIGURE 1 (PAGE 5) FOR INSTALLATION OF GRILLE GUARD. INSTALLATION MAYBE EASIER WITH ENTIRE HOOD REMOVED TO OBTAIN ACCESS TO THE FRONT MOST BOLT ON THE TOW HOOKS WHICH IS LOCATED IN A CHANNEL DIFFICULT TO ACCESS OTHERWISE.
2. REMOVE BOTH LEFT AND RIGHT HAND TOW HOOKS FROM VEHICLE. THE GRILLE GUARD MOUNTING BRACKETS ARE SANDWICHED BETWEEN THE FRAME AND THE TOW HOOKS ON BOTH SIDES. LONGER HARDWARE IS PROVIDED TO COMPLETE THE INSTALLATION, FACTORY HARDWARE CAN BE DISCARDED.
3. POSITION EACH BRACKET TO LINE UP WITH THE FRONT MOST HOLES IN THE TOW HOOK. OUR BRACKET INCLUDES A CLEARANCE HOLE TO GO AROUND A BOLT IN THE FRAME WHICH DOES NOT NEED TO BE REMOVED.
4. USING SUPPLIED HARDWARE, REINSTALL TOW HOOKS AND MOUNTING BRACKETS TO FRAME USING THE TWO FRONT MOST HOLES IN THE TOW HOOK. DO NOT FULLY TIGHTEN YET.
5. PLACE SUPPLIED STEEL SPACERS ABOVE TOW HOOKS REAR TWO HOLES AND TIGHTEN WITH SUPPLIED HARDWARE TO FRAME LOOSELY FOR ADJUSTMENT IN NEXT STEP.
6. HOLDING THE RING ASSEMBLY IN PLACE, INSERT THE LOWER 5/8" DIA. CLEVIS PINS AND HAIR PINS TO ATTACH GUARD TO MOUNTING BRACKETS.
7. LIFT GUARD UNTIL UPRIGHTS STOP ON RUBBER DAMPENERS AND LATCH RUBBER STRAPS TO UPRIGHTS. THIS WILL SECURE GUARD DURING OPERATION, HOWEVER EXTRA 5/8" DIA. CLEVIS PINS AND HAIR PINS ARE SUPPLIED FOR ADDED SECURITY AND STRENGTH DURING OPERATION AND CAN BE USED INDIVIDUALLY OR TOGETHER.

**CLASS 8 FREIGHTLINER COLUMBIA
(2ND HALF 2002-CURRENT)**

INSTALLATION INSTRUCTIONS (CONTINUED)

8. AFTER GUARD HAS BEEN FULLY INSTALLED AND OPERABLE, CLOSE GUARD AND TIGHTEN ALL FASTENERS.

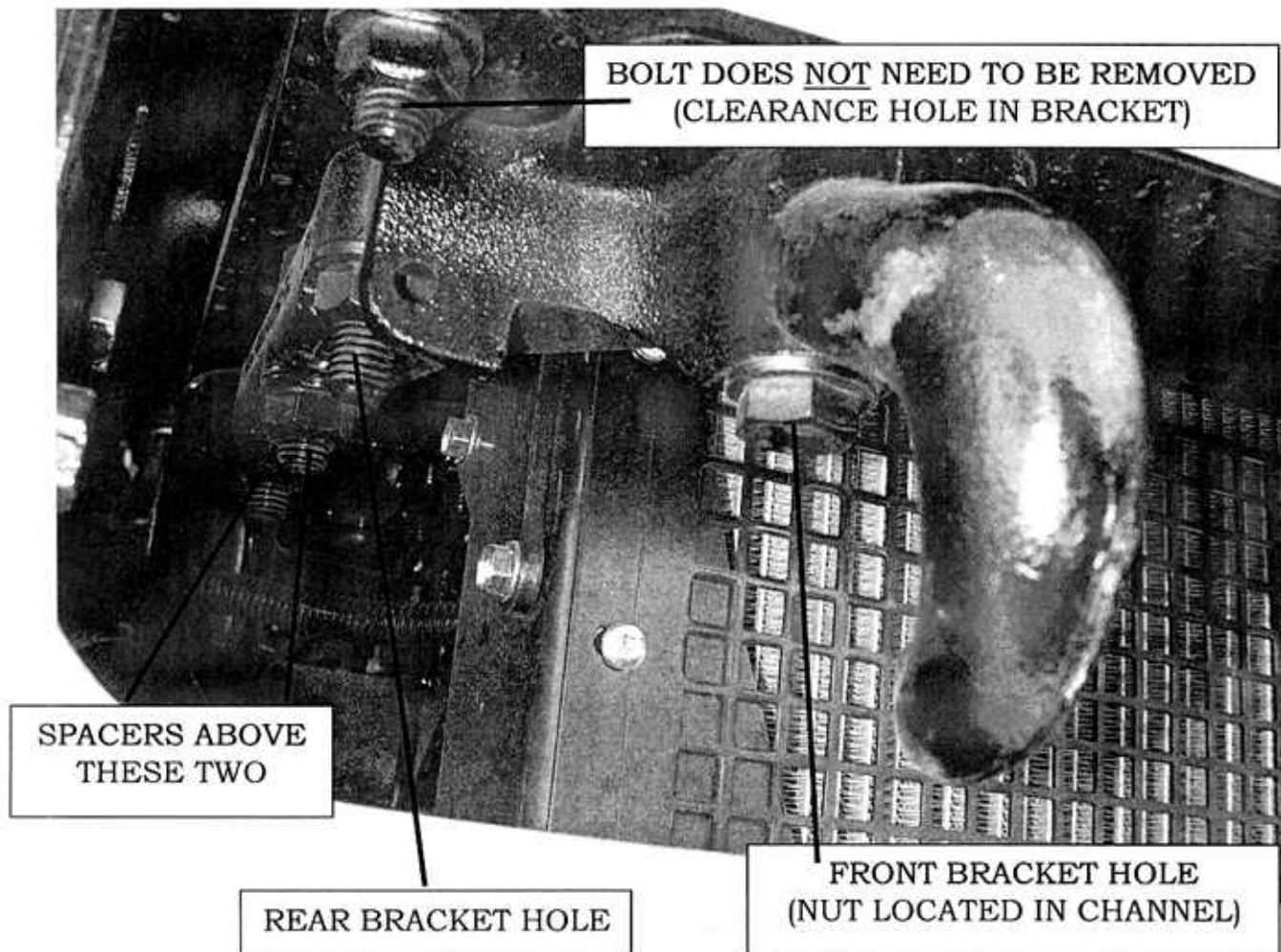

**CLASS 8 FREIGHTLINER COLUMBIA
(2ND HALF 2002-CURRENT)**

OPERATING INSTRUCTIONS

ONCE THE GUARD HAS BEEN INSTALLED PROPERLY, THE GUARD MUST BE MANUALLY LOWERED AND RAISED FOR THE HOOD TO OPEN AND CLOSE. THE HOOD CAN NOT BE OPENED WITH THE GUARD IN THE OPERATING POSITION.

OPENING HOOD

1. REMOVE THE UPPER SAFETY CLEVIS PINS AND HAIR PINS.
2. RELEASE RUBBER STRAPS FROM UPRIGHTS AND CAREFULLY LOWER THE GUARD UNTIL IT STOPS ON ITSELF.
3. OPEN THE HOOD AS USUAL.

CLOSING HOOD

1. CLOSE THE HOOD AS USUAL, REMEMBERING TO STEP THROUGH THE GUARD AND NOT ON THE GUARD.
2. LIFT GUARD BACK TO OPERATING POSITION AND LATCH RUBBER STRAPS TO UPRIGHTS.
3. REINSERT THE UPPER SAFETY CLEVIS PINS AND HAIR PINS FOR ADDED SECURITY AND STRENGTH.

REMOVING GUARD

1. IF THE GRILLE GUARD EVER NEEDS TO BE REMOVED FROM THE TRUCK, LOWER THE GUARD TO THE OPEN POSITION.
2. REMOVE THE TWO LOWER HAIR PINS FROM THE GUARD.
3. AFTER BOTH HAIR PINS HAVE BEEN REMOVED, SUPPORT THE GUARD AND CAREFULLY REMOVE THE CLEVIS PINS FROM BOTH UPRIGHTS.
4. THE GUARD IS NOW UNATTACHED FROM THE TRUCK.

**CLASS 8 FREIGHTLINER COLUMBIA
 (2ND HALF 2002-CURRENT)**

SERVICE PARTS LIST

ITEM	PART NO.	QTY	DESCRIPTION
1	100148	8	WASHER-LOCK, SPLIT, 5/8, ZP
2	100149	8	NUT-HEX, 5/8-11, ZP
3	100159	4	PIN-HAIR, ZP
4	100946	2	DAMPENER-RUBBER, BLACK
5	103147	8	SCR-BUTTON HEAD, SST, 10-24 X 1/2
6	105260	1	SAFETY WALK-BLACK, 19 X 2.5
7	105263	4	PIN-MACHINE, CLEVIS, 5/8 X 3-5/8, ZP
8	106683	2	STRAP-HOOD, BLACK, RUBBER, 5.125
9	106684	4	WASHER-LOCK, SST, #10
10	106685	4	ACORN-NUT, SST, 10-24
11	107431	4	SPACER-STEEL, 1.50 X 0.688 X 0.500, ZP
12	107432	16	WASHER-FLAT, 1.313 X 0.656 X 0.095, 5/8 SAE
13	107433	6	SCR-HEX HEAD, ZP, 5/8-11 X 3.50, GRADE 8
14	107434	2	SCR-HEX HEAD, ZP, 5/8-11 X 4.50, GRADE 8
15	205232	1	RING ASSEMBLY-FREIGHTLINER COLUMBIA
16	205238	1	BRACKET-MTG, WELDMENT, BLACK, LH
17	205239	1	BRACKET-MTG, WELDMENT, BLACK, RH

SERVICE PARTS DRAWING

MODEL NO. - 205230

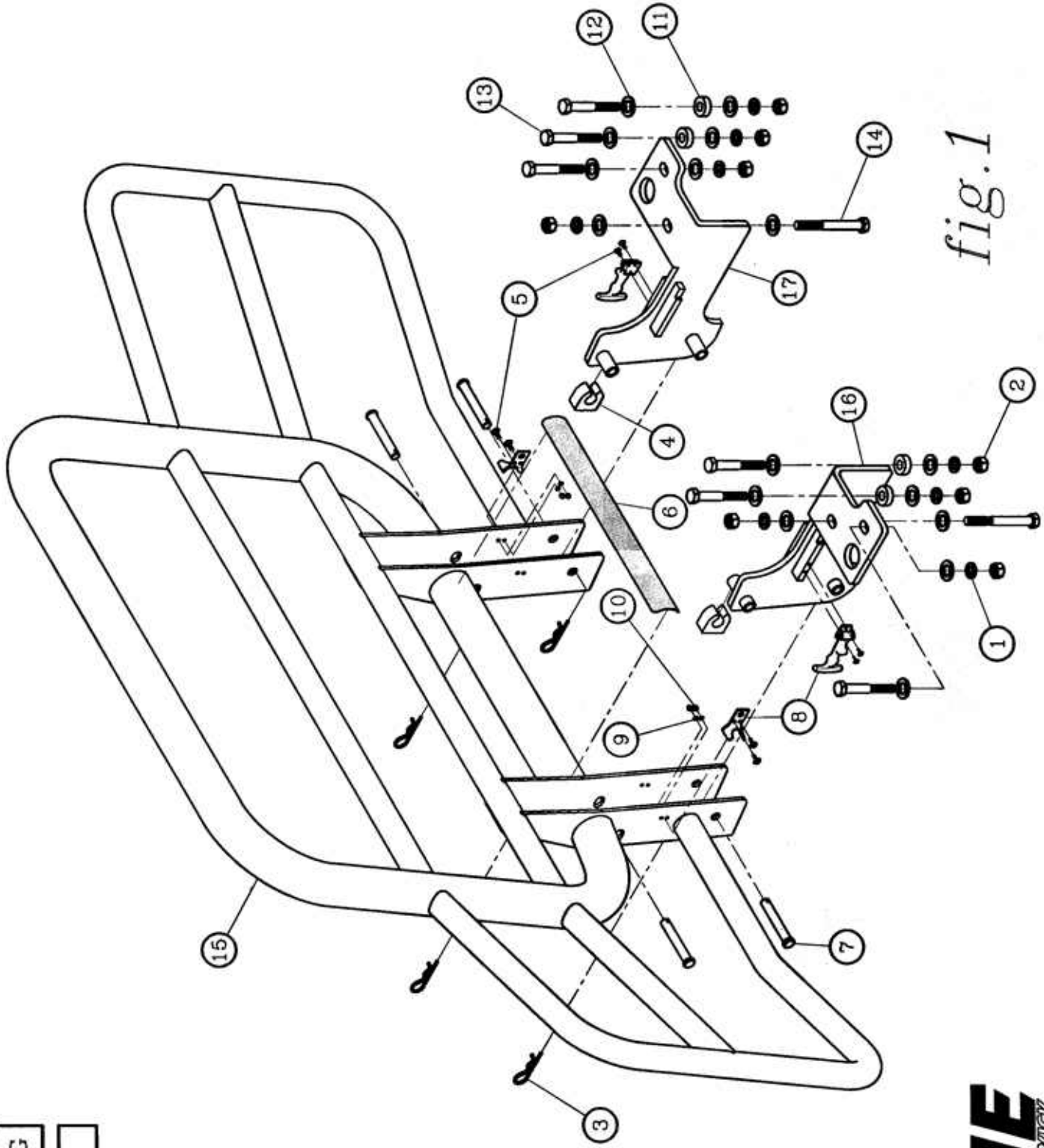

fig. 1

LAMVERNE
ISO9001/QS9000 CERTIFIED
TRUCK EQUIPMENT
INC
1200 Birch Street
Brandon, SD 57005