

INSTALLATION INSTRUCTIONS AND PARTS LIST

APPL: 45/460434 STEEL (BLACK) & STAINLESS STEEL NERF BARS ON:
2004 AND NEWER DODGE DURANGO



1. READ INSTRUCTIONS COMPLETELY AND CHECK TO MAKE SURE THAT ALL REQUIRED PARTS (LISTED ON SERVICE PARTS LIST) ARE ON HAND BEFORE STARTING THE INSTALLATION.
2. NERF BAR TUBE AND MOUNTING BRACKET ASSEMBLIES ARE PRE-ASSEMBLED.
 - 2.1. THE REAR MOUNTING BRACKETS ON THESE ASSEMBLIES ARE ROTATED TO THE FRONT (INBOARD OF LEGS) FOR SHIPPING PURPOSES. THESE BRACKETS MUST BE ROTATED TO THE VERTICAL POSITION AND THE ½" BOLTS MUST BE TORQUED TO 65 LB. FT
3. REMOVE THE FOUR (4) APPLICABLE BODY MOUNT BOLTS FROM THE VEHICLE. (THESE ARE M12-1.75 METRIC BOLTS).
 - 3.1. NONE OF THESE BOLTS ARE REUSED IN THIS INSTALLATION.
 - 3.2. THE BODY MOUNT STEEL WASHER PLATES WITH RUBBER CUSHIONS ARE REUSED BETWEEN THE BODY MOUNT AND THE NERF BAR MOUNTING BRACKET.
4. POSITION THE NERF BAR ASSEMBLY UP UNDER THE BODY MOUNTS: (NOTE: LUVERNE DECAL IS ON THE FRONT DRIVER SIDE).
 - 4.1. ON THE FRONT MOUNT, INSTALL THE M12-1.75 X 110mm (APPROX. 4-3/8" LONG) HEX HEAD BOLT (ITEM #3), ½" LOCK WASHER (ITEM #4) AND ½" FLAT WASHER (ITEM #5) UP THRU THE HOLE IN THE NERF BAR MOUNTING BRACKET AND THE BODY MOUNTING WASHER PLATE AND CUSHION AS SHOWN.
 - 4.2. REPEAT OPERATION 4.1 FOR THE REAR MOUNT.
 - 4.3. TORQUE ALL M12-1.75 BODY MOUNTING BOLTS TO 45 LB. FT.

SERVICE PARTS LIST

ITEM	PART NO.	QTY	DESCRIPTION
1	549018	1	NERF BAR WLDMT- LH,SST,460434
2	549017	1	NERF BAR WLDMT- RH,SST,460434
1	549023	1	NERF BAR WLDMT- LH,STL,BLACK,450434
2	549022	1	NERF BAR WLDMT- RH,STL,BLACK,450434
3	103444	4	BOLT-HEX HD CAP,M12-1.75 X 110mm,ZP
4	100121	4	WASHER-LOCK,1/2",ZP
5	100118	4	WASHER-FLAT,1/2",ZP
6	104249	4	BOLT-HEX HD CAP, SEER FNGE, 1/2 -13 X 2.00, ZP
7	549019	2	BRKT-MTG, NB, DURANGO, LH/RH, REAR
8	548645	2	BRKT-MTG, NB, GM, LH/RH, FRONT
9	103950	4	PAD-STEP, NB, BLK, 20.00 LG

SERVICE PARTS LIST

MODEL NO. -450434 (BLACK)
 -460434 (SST)

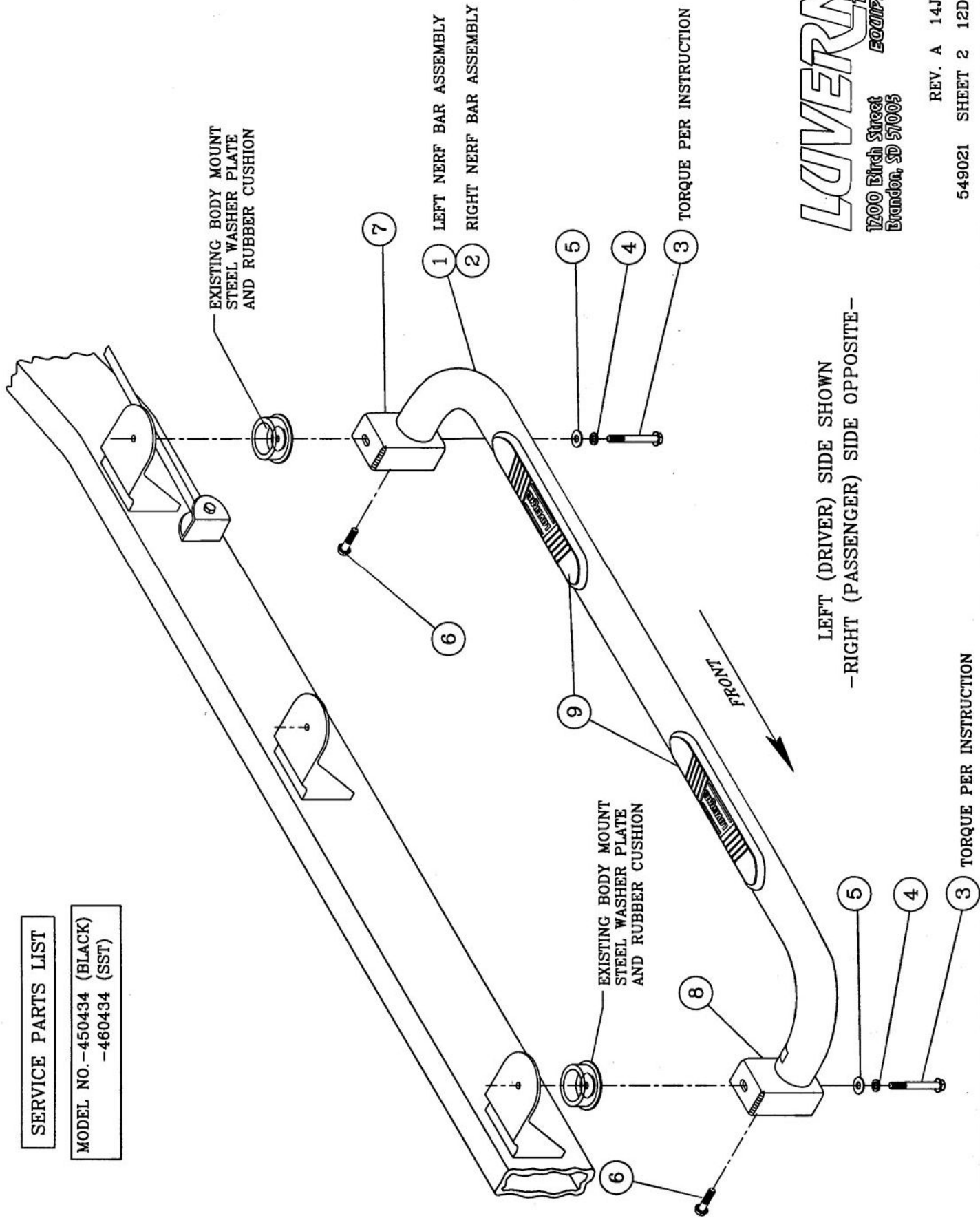

LAVERGNE TRUCK EQUIPMENT INC.
 1200 Birch Street
 Brandon, MD 57005

REV. A 14JUL04
 549021 SHEET 2 12DEC03

LEFT (DRIVER) SIDE SHOWN
 -RIGHT (PASSENGER) SIDE OPPOSITE-