

INSTALLATION INSTRUCTIONS AND PARTS LIST

APPLICATION: 450014 AND 460014 NERF BARS:
 2000 AND NEWER CHEVROLET/GMC 1500 SERIES SUBURBAN / YUKON XL VEHICLES
 2002 AND NEWER CHEVROLET 1500 SERIES AVALANCHE VEHICLES



NO DRILL INSTALLATION

1. READ INSTRUCTIONS COMPLETELY AND CHECK TO MAKE SURE THAT ALL REQUIRED PARTS (LISTED ON SERVICE PARTS LIST) ARE ON HAND BEFORE STARTING THE INSTALLATION.
2. ASSEMBLE THE NERF BAR TUBES AND MOUNTING BRACKETS AS FOLLOWS.
 NOTE: THE 1" X 3" SERIAL NUMBER DECAL IS LOCATED ON THE FRONT LEG OF THE LEFT (DRIVERS SIDE) NERF BAR ASSEMBLY.
 - 2.1 LAY THE NERF BAR/PAD ASSEMBLIES (ITEM #1) ON A FLAT SURFACE. (LEFT & RIGHT HAND ASSEMBLIES SHOULD BE MIRROR IMAGES OF ONE ANOTHER).
 - 2.2 ATTACH THE FRONT (5-1/4" TALL) BRACKET (ITEM #3) AND REAR (7-5/8" TALL) BRACKET (ITEM #4) TO THE NERF BAR AS SHOWN. USE 1/2-13 X 2" LONG HEX HEAD BOLTS (ITEM #5). TORQUE THESE BOLTS TO 65 LB. FT.
3. REMOVE THE FOUR (4) APPLICABLE FACTORY BODY MOUNT BOLTS FROM THE VEHICLE.
 - 3.1 THESE FOUR (4) BOLTS ARE REUSED IN THIS INSTALLATION.
 - 3.2 THE BODY MOUNT STEEL WASHER PLATES WITH RUBBER CUSHIONS ARE REUSED BETWEEN THE BODY MOUNT AND THE NERF BAR MOUNTING BRACKET.
4. POSITION THE NERF BAR ASSEMBLY UP UNDER THE VEHICLE AND ATTACH THE FRONT AND REAR BRACKETS TO THE BODY MOUNTS WITH FACTORY BODY MOUNT BOLTS AS SHOWN.
 - 4.1 ON MODEL YEAR 2000 THRU 2005: IF THE BODY MOUNT BOLT IS 110mm (4-3/8") LONG, **DO NOT USE THE 1/2" FLAT WASHERS (ITEM #6 & #7).**
 - 4.2 ON MODEL YEAR 2000 THRU 2005: IF THE BODY MOUNT BOLT IS 120mm (4-3/4") LONG, **USE THE 1/2" FLAT WASHERS (ITEM #6 & #7).**
 - 4.3 ON MODEL YEAR 2006 TO CURRENT: **USE THE EXISTING M14-2.00 X 120mm (4-3/4") LONG FACTORY BODY MOUNT BOLT AND 1/2" FLAT WASHERS (ITEM #6 & #7).**
 - 4.4 TORQUE ALL BODY MOUNT BOLTS TO 65 LB. FT.

SERVICE PARTS LIST

ITEM	PART NO.	QTY	DESCRIPTION
1	549095	2	NERF BAR WLDMT – SST, LH & RH, 460014
1	549105	2	NERF BAR WLDMT – BLACK, LH & RH, 450014
2	103950	4	PAD- STEP, NB, BLK, 20.00 LG
3	550130	2	BRKT- MTG, NB, LH/RH, FRT, TAHOE
4	549077	2	BRKT- MTG, NB, SUB/YUKON XL 1500,LH/RH, REAR
5	104249	4	BOLT-HEX HD CAP, SERRFLG, 1/2 X 2.00" LG,ZP
6	100118	2	WASHER- FLAT,.562 ID X 1.38 OD X .109 T, ZP
7	103779	2	WASHER- CLIPPED, FLAT,.1/2", ZP

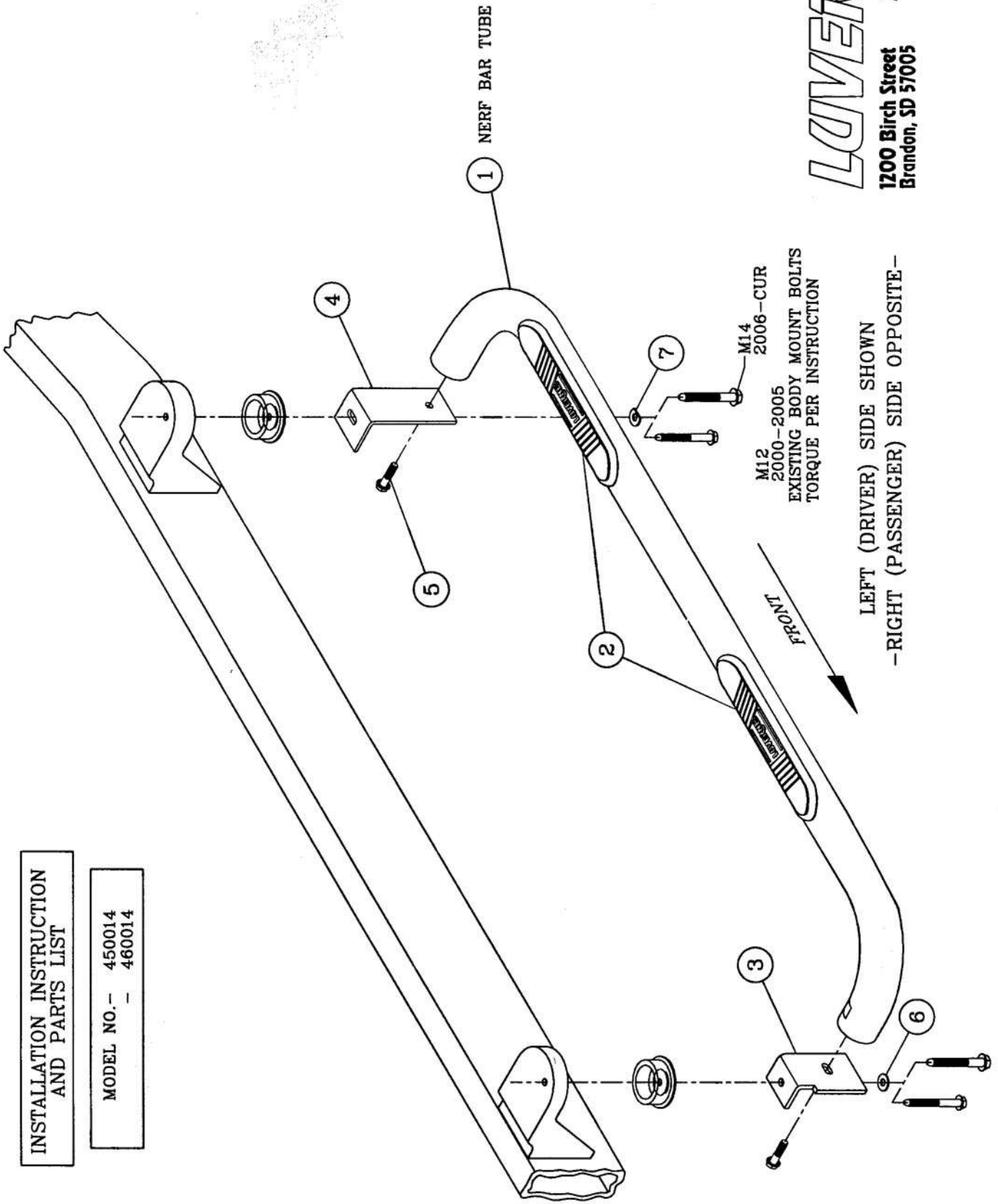

**INSTALLATION INSTRUCTION
 AND PARTS LIST**

MODEL NO. -	450014
-	460014