

## INSTALLATION INSTRUCTIONS AND PARTS LIST

**APPL: C9911 SERIES POLISHED STAINLESS STEEL & BLACK NERF BARS ON:  
1999 AND NEWER CHEVROLET/GMC REGULAR CAB PICKUPS  
2001 AND NEWER CHEVROLET/GMC HEAVY DUTY REGULAR CAB PICKUPS**

1. READ INSTRUCTIONS COMPLETELY AND CHECK TO MAKE SURE THAT ALL REQUIRED PARTS (LISTED ON SERVICE PARTS LIST) ARE ON HAND BEFORE STARTING THE INSTALLATION.
2. NERF BAR TUBE AND MOUNTING BRACKET ASSEMBLIES (ITEM #1 & #2) ARE PRE-ASSEMBLED.  
NOTE: THE 1" X 3" SERIAL NUMBER DECAL IS LOCATED ON THE FRONT LEG OF THE LEFT (DRIVERS SIDE) NERF BAR ASSEMBLY.
3. REMOVE THE FOUR (4) APPLICABLE FACTORY BODY MOUNT BOLTS FROM THE VEHICLE.
  - 3.1 THESE FOUR (4) BOLTS ARE REUSED IN THIS INSTALLATION.
  - 3.2 THE BODY MOUNT STEEL WASHER PLATES WITH RUBBER CUSHIONS ARE REUSED BETWEEN THE BODY MOUNT AND THE NERF BAR MOUNTING BRACKET.
4. POSITION THE NERF BAR ASSEMBLY UP UNDER THE VEHICLE AND ATTACH THE FRONT AND REAR BRACKETS TO THE BODY MOUNTS WITH FACTORY BODY MOUNT BOLTS AS SHOWN.
  - 4.1 ON MODEL YEAR 1999 THRU 2005: IF THE BODY MOUNT BOLT IS 110mm (4-3/8") LONG, **DO NOT USE THE 1/2" FLAT WASHER (ITEM #3).**
  - 4.2 ON MODEL YEAR 1999 THRU 2005: IF THE BODY MOUNT BOLT IS 120mm (4-3/4") LONG, **USE THE 1/2" FLAT WASHER (ITEM #3).**
  - 4.3 ON MODEL YEAR 2006 TO CURRENT: **USE THE EXISTING M14-2.00 X 120mm (4-3/4") LONG FACTORY BODY MOUNT BOLT AND 1/2" FLAT WASHER (ITEM #3).**
  - 4.4 **TORQUE ALL BODY MOUNT BOLTS TO 65 LB. FT.**

### SERVICE PARTS LIST

ITEM	PART NO.	QTY	DESCRIPTION
1	548639	1	NERF BAR/BRKT ASSY- GM,REG CAB,LH,POL,C9911SST
2	548640	1	NERF BAR/BRKT ASSY- GM,REG CAB,RH,POL,C9911SST
1	548651	1	NERF BAR/BRKT ASSY- GM,REG CAB,LH,BLK,C9911TB
2	548652	1	NERF BAR/BRKT ASSY- GM,REG CAB,RH,BLK,C9911TB
3	100118	4	WASHER-FLAT,.562 ID X 1.38 OD X .109 T,ZP

**LIVERNE**  
ISO9001/ISO9000 CERTIFIED TRUCK  
EQUIPMENT  
1200 Birch Street  
Brandon, SD 57005  
INC.

REV A 29 AUG 05  
548638 SHEET 1 AUG 98

SERVICE PARTS LIST

MODEL NO. -C9911SST SER  
-C9911TB SER

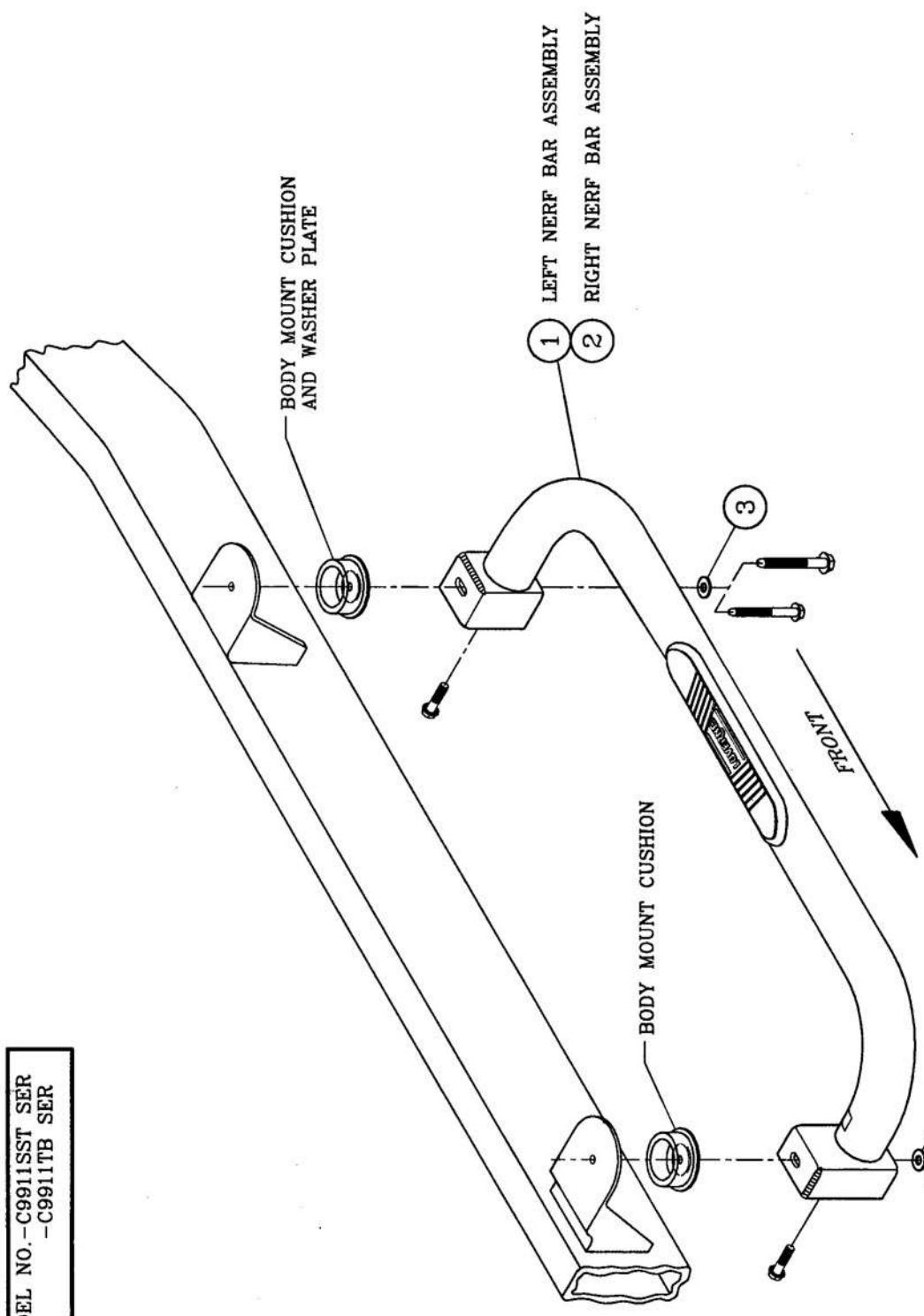

LEFT (DRIVER) SIDE SHOWN  
-RIGHT (PASSENGER) SIDE OPPOSITE-

M12  
1999-2005  
EXISTING BODY MOUNT BOLTS  
TORQUE PER INSTRUCTION

M14  
2006-CUR