



(A LIVERNE Company)

1200 E. Birch St.

Brandon, SD 57005

## **CLASS 8 VOLVO VN (2004-CURRENT)**

THIS GRILLE GUARD WILL FIT ALL NEW VOLVO VN'S WITH THE NEW STYLE HEADLIGHTS FROM 2004-CURRENT. IT WILL NOT FIT THE VOLVO VNM200 SINCE IT HAS THE OLD STYLE HEADLIGHTS. THIS GUARD HAS BEEN DESIGNED FOR THE VOLVO VN780, VN670, VN630, VN430 & VNL300. ANY OTHER TRUCKS MAY REQUIRE MODIFICATIONS TO THE TRUCK OR TO THE GUARD ITSELF.

### **INSTALLATION INSTRUCTIONS**

*READ THE INSTRUCTIONS COMPLETELY AND CHECK TO MAKE SURE THAT ALL OF THE REQUIRED PARTS ARE ON HAND BEFORE STARTING THE INSTALLATION.*

1. INSERT LEFT AND RIGHT HAND MOUNTING BRACKETS IN TOW HOOK RECEIVERS ON TRUCK. YOU MUST USE THE VOLVO SUPPLIED 3/4" DIA. CLEVIS PINS AND HAIR PINS (OR EQUIVALENT) TO ATTACH THE MOUNTING BRACKETS.
2. USING THE 5/8-11 X 2" BOLTS (ITEM #11), 9/16" FLAT WASHERS (ITEM #13) AND 5/8-11 NYLOCK NUTS (ITEM #7), ATTACH THE ADAPTOR PLATES (ITEM #2) TO THE GUARD USING THE TOP HOLES ONLY.
3. USING THE 5/8-11 X 2.50" BOLTS (ITEM #12), 9/16" FLAT WASHERS (ITEM #13), 5/8-11 NYLOCKS (ITEM #7) AND THE NYLON WASHERS (ITEM #14), ATTACH THE GUARD WITH ADAPTOR PLATES TO THE MOUNTING BRACKETS LOWER HOLES.
4. SECURE THE GUARD TO THE ADAPTOR PLATES WITH THE CLEVIS PINS (ITEM #8) AND THE HAIR PINS (ITEM #9).
5. SNUG UP THE LOWER 5/8-11 NYLOCK NUTS SO THAT THE GUARD IS SNUG BUT WILL STILL ROTATE EASILY WHEN LOWERING THE GUARD TO OPEN THE HOOD.
6. INSTALL THE 1/2-13 X 1" BOLTS (ITEM #10) AND THE 1/2-13 NYLOCK NUTS (ITEM #6) THAT ARE USED AS STOPS WHEN LOWERING THE GUARD. ALIGN A FLAT SIDE OF THE BOLT HEAD WITH THE FLAT SURFACE OF THE ADAPTOR PLATE AND TIGHTEN THE NUT.



(A LIVERNE Company)

1200 E. Birch St.

Brandon, SD 57005

## CLASS 8 VOLVO VN (2004-CURRENT)

### SERVICE PARTS LIST

ITEM	PART NO.	QTY	DESCRIPTION
1	205500	1	GUARD - TUBULAR, 3" SST
	205501		GUARD - TUBULAR, 3" BLACK
2	205627	2	ADAPTOR - PLATE, ZP
3	102500	4	INSERT - FINISH, BLACK, 3"
4	205623	1	MOUNTING BRACKET - LH, ZP
5	205626	1	MOUNTING BRACKET - RH, ZP
6	105654	2	NUT - NYLOCK, 1/2-13, ZP
7	107435	4	NUT - NYLOCK, 5/8-11, ZP
8	107438	2	PIN - CLEVIS, 5/8 X 2
9	100159	2	PIN - HAIR, 9GA, ZP
10	100085	2	SCREW - HEX HEAD, 1/2-13 X 1, ZP
11	100144	2	SCREW - HEX HEAD, 5/8-12 X 2, ZP
12	100145	2	SCREW - HEX HEAD, 5/8-12 X 2.50, ZP
13	100140	8	WASHER - FLAT, 9/16, USS, ZP
14	102149	4	WASHER - NYLON, 1 OD X 5/8 ID X 1/32

SERVICE PARTS DRAWING

MODEL NO. - 205620

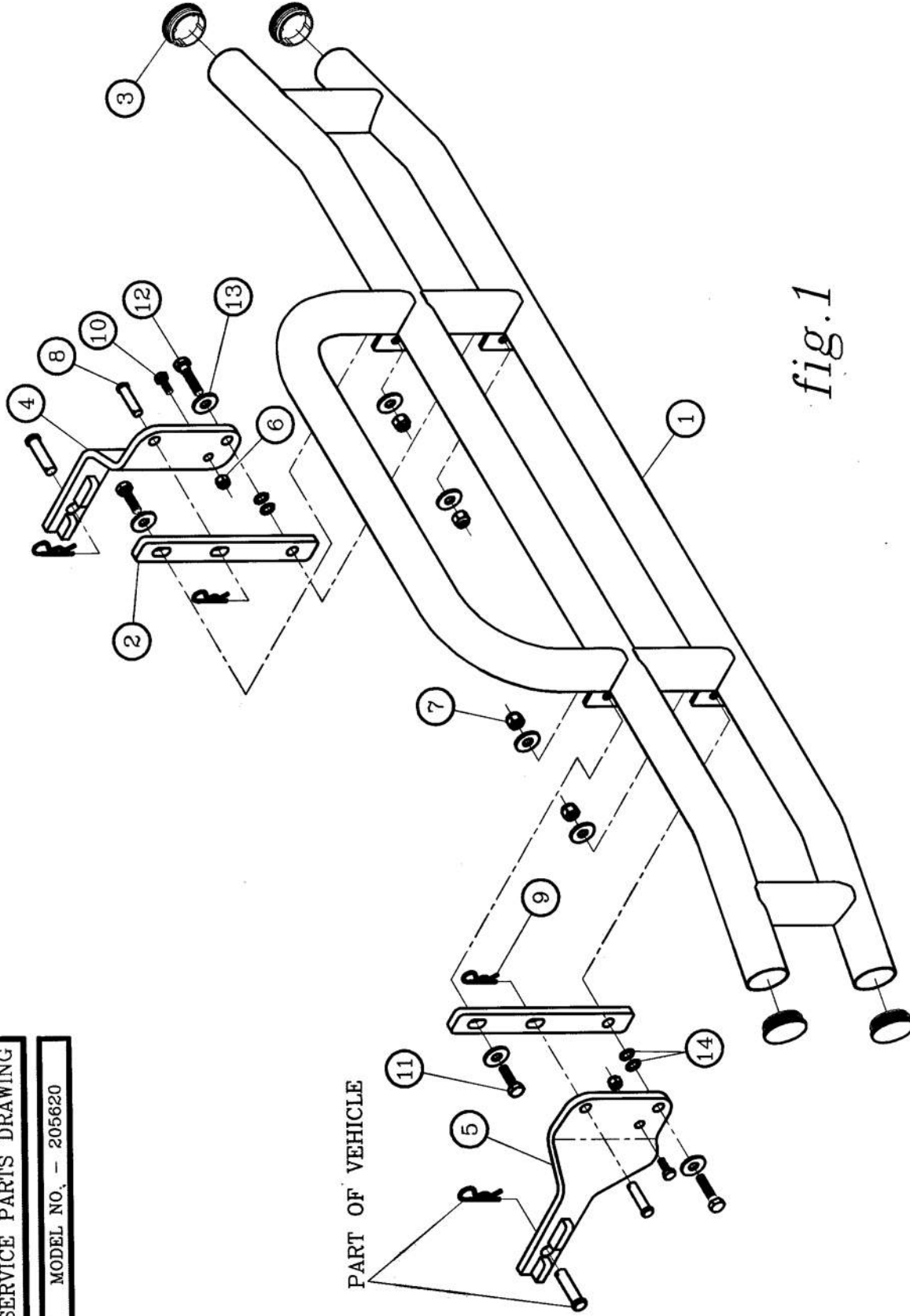

fig. 1

**LIVERNE**  
TRUCK EQUIPMENT  
(A LIVERNE Company)

1200 E. Birch St.  
Brandon, SD 57005